



**CKPOWER.COM**



**1-855-CKPOWER**

**CKPOWER<sup>®</sup>**

**CK7G-HC1**



EFI Commercial 7kW Generator  
2020 Spec Sheet

# CK7G-HC1

## Features:

- 6-Point isolation system
- Fresh air engine cooling system
- 12-Pin Deutsch connector standard
- Horizontal front facing belt drive system
- Easy-to-access oil and air filter
- Access to oil dipstick for daily maintenance
- Easy access engine oil drain assembly with ball valve
- Service light with blinking error code detection
- All units come in the color *Glacier White*



**Unit available in both LP and Gasoline models.  
Robust and air cooled!**

## Options:

- Remote analog panel with 20' harness
- Generator slide out tray system (custom options available)
- External fan kit when mounting genset into a box or compartment
- Hydraulic pump kit available for new or field add on (max PSI of 3,988 and 2.4 gpm)
- Custom air intake panel when mounting genset into a box or compartment

**Battery, mount, and cables required, but are not included. Must be remote mounted.**

## BASIC DIMENSIONS:

LENGTH	WIDTH	HEIGHT	DRY WEIGHT	CIRCUIT BREAKER
33.59 in.	23.44 in.	23.09 in.	300 lbs.	30 Amp Double Pole

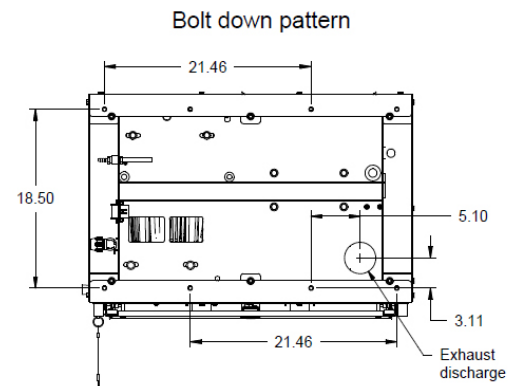
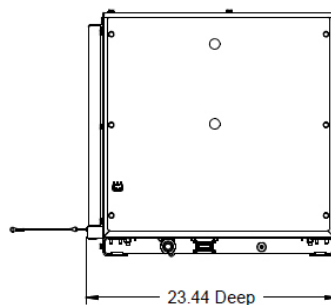
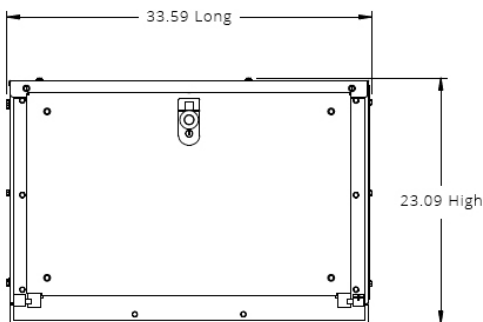

## SPECIFICATION OF ENGINE:

MODEL	WATTAGE		DISPLACEMENT	ALTERNATOR	AMPS (240 VOLT)	
	STARTING	CONT			MAX	CONT
Kohler ECH730	7,500	7,000	747 cc	DOUBLE BEARING	33.3	30

\* Command Pro EFI

\* Single Phase

\* Specification subject to change without notice.\*

Not responsible for typographical errors. All prices and specifications are subject to change without prior notice. All prices are confidential.



### SINGLE SIDE SERVICE DOOR:

- Quick and easy removable lid to access components requiring maintenance.
- Belts
- Oil filter
- Oil drain
- Air filter
- Dipstick
- Fuel filter
- Control panel



### WARRANTY:

- 2 Years or 1,000 hours from the date of installation on all major components
- Return-less EFI system, requires supply line only
- No return fuel line required
- Decibel level @ 15 ft. on typical installation of 69 db



### REMOTE & CONTROL PANELS:



#### Gasoline:

- CK7G-HC1 (Analog)

#### Propane:

- CK7P-HC1 (Analog)
- Coming Soon!

### GENSET(S) OFFERED:

PART	DESCRIPTION
CK7RP (Analog)	20' Remote start panel assembly with start/stop switch, green generator on indicator light, hour meter mounted on a small flate plate with CK Power logo on it.
CK7HK	Hydraulic pump add on kit. Sold as an add on option that either CK Power or the customer can install. All genset(s), both propane or gasoline have the ability to add either a hydraulic pump option or remote start system.
CK7SH	Slide out drawer system - horizontal mount
CK7SV	Slide out drawer system - vertical mount
CK7FK	Ship Loose fan kit when mounting in an enclosed box
CK7AIP	Ship Loose air intake panel when mounting in a box or compartment
CK7TP	Tail pipe kit extension - 2ft. long

### FUEL CONSUMPTION:

LOAD (KW)	FUEL WEIGHT		CONSUMPTION	
	BEGINNING	ENDING	TOTAL	GAL/HR
-				
1,750	11.73	7.59	4.14	0.70
3,500	11.63	4.52	7.11	1.20
5,250	11.73	3.13	8.60	1.45
7,000	11.48	2.51	8.94	1.50

\* Decibel chart to be updated soon with final lower numbers.

### DECIBEL CHART:

LOAD (KW)		DISTANCE (FT.)		INTENSITY (DB.)	
BACK	FRONT	BACK	FRONT	BACK	FRONT
0% (0)	0% (0)	15	15	71.5	71
50% (3.5)	50% (3.5)	15	15	73	73
100% (7)	100% (7)	15	15	73	75.5
0% (0)	0% (0)	25	25	68.5	68
50% (3.5)	50% (3.5)	25	25	69	69.5
100% (7)	100% (7)	25	25	69	71.5

LOAD (KW)		DISTANCE (FT.)		INTENSITY (DB.)	
ENGINE	ALTERNATOR	ENGINE	ALTERNATOR	ENGINE	ALTERNATOR
0% (0)	0% (0)	15	15	70.5	70
50% (3.5)	50% (3.5)	15	15	72	71
100% (7)	100% (7)	15	15	75	74
0% (0)	0% (0)	25	25	67	66.5
50% (3.5)	50% (3.5)	25	25	69	67.5
100% (7)	100% (7)	25	25	71	70

**Oil Cooler Kit  
(Standard)**

**Drive Belt  
(2 ea.)**



#### Improvements over the competition:

- Kohler's top of the line, command pro EFI series engine
- Reduced engine and housing temperatures
- Internal cooling fan with 13" diameter designed to evacuate hot air out of compartment
- Standard engine oil cooler kit for additional engine cooling temperatures under extreme conditions
- 10-Minute change out. Dual tri-power BX39 gates V-belts for added security with ease of replacement without disassembling unit
- Easy access single side service with removable access door in 5 minutes or less
- Removable lid for easy service when required by removing two screws
- 8kW copper wound dual bearing generator with automatic voltage regulator designed to run 7kW continuous
- All internal brackets and covers are made from aluminum and powder-coated with a TGIC powder for long life expectancy in an outdoor environment
- Very low to no oil consumption when engine is properly maintained for 3,000 hours or more life expectancy
- Robust heavy duty air cleaner assembly designed for extreme environments
- Hi-temp and low oil pressure shut down safeties
- Return-less fuel system does not require a return fuel line, only suction from the tank

### **Kohler ECH730 EFI Engine with 3,000 RPM Governor:**

- Fuel injection engine for ease of starting and fuel economy
- Industrial pressure lubrication with low oil shutdown
- Low engine operating temps minimize oil consumption
- Large Donaldson air cleaner with custom hose
- Kohler's fuel pump for the EFI
- Kohler's heavy duty Donaldson round air cleaner kit
- Kohler oil cooler kit option (standard)
- DC cooling 1,100 CFM fan, standard for added cooling
- Cold Test: ran and approved to -30F using 5W-30 Oil
- Heat Test: ran and approved to 110F using 10W-40 Oil
- Testing approved using a 550 CCA Battery



### **2-Bearing Key Shaft Alternator:**

- CK Power manufactured brush type with AVR
- Carbon brushes for long life (1,000 hours)
- Rating: 8kW | Insulation Class: F
- CE certificate

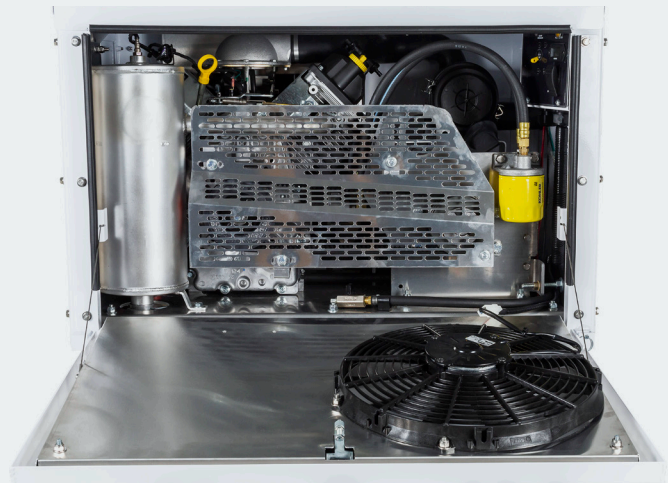

## **DIGITAL RESOURCES:** **Want to learn more?**

**Visit:** <https://www.ckpower.com/7kwgenset/>

- Get downloadable materials such as schematics, blink codes, Kohler manuals and warranties.
- View up close images!

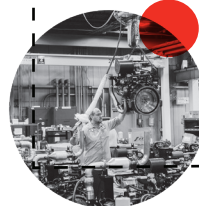

# CK POWER®

## LIMITED WARRANTY

CK Power warrants to the original consumer, for the period listed below, each product of its manufacture is free from defects in material and workmanship. This warranty is limited to repair, replacement, or adjustment, without charge, as CK Power elects. Product found to be defective in material or workmanship, if it is found to be properly installed, maintained, and operated, and provide CK Power is notified of such defect within the applicable warranty period and given a reasonable time to correct the defect. This warranty does not apply to malfunctions caused by misuse, unreasonable use, negligence, accident, improper installation, misapplication, repair or service by third parties, or normal wear and tear.

### DESCRIPTION & WARRANTY COVERAGE\*:

Mobile Power Generator Set & Accessories

One (2) Year or 1,000 Hours (*Whichever occurs first*)

*\* Calculated from delivery to original consumer, not to exceed 24 months from shipment by CK Power.*

### *The following are not covered by the limited warranty:*

- Normal wear, adjustments, and routine maintenance
- Damage caused by accidents, improper handling or installation
- Damage caused by improper installation, operation maintenance, or alterations
- Damage caused by defects in the total system in which the generator is installed
- Installation and start-up costs
- Starting batteries
- Parts purchased from other than CK Power
- Engine fluids (oil, anti-freeze, grease)
- Miscellaneous shop supplies (rags, solvents, adhesives)
- Overtime labor
- Maintenance items (belts, filters, hoses, sparkplugs, fuses, lamps and clamps)
- Travel and mileage expenses on mobile units
- Rental of equipment during performance of warranty repairs

**CK Power shall not be liable for any loss, damage, or expense** directly or indirectly from the use of this product, nor for the fitness of this product for any specific application or particular purpose.



**CK Power shall not be liable for any special, incidental, or consequential damages of any kind** including, but not limited to labor, installation, communication, transportation, rental and living expenses in connection with the replacement or repair of defective parts.

**This is our exclusive written limited warranty**, we make no other express warranty. No person or agent, distributor, dealer, or service station is authorized to give any other warranties on behalf of CK Power or assume for CK Power any other liability in connection with any of its products.

**To obtain warranty service call 314-868-8620 or write CK Power Warranty Department 1100 Research Blvd. St. Louis, MO 63132**